

Live a GRAND LIFE





About Arttech Affordable Housing LLP

Bringing affordable housing while upholding the highest standards of professionalism.

Arttech Affordable Housing LLP is promoted by veterans in the real estate industry. To their credit they have successfully developed, delivered & well habited group housing, commercial projects such as The Ozone Park Apartments, Ozone Centre, Sai Park Apartments, Sai Vatika Apartments in Faridabad

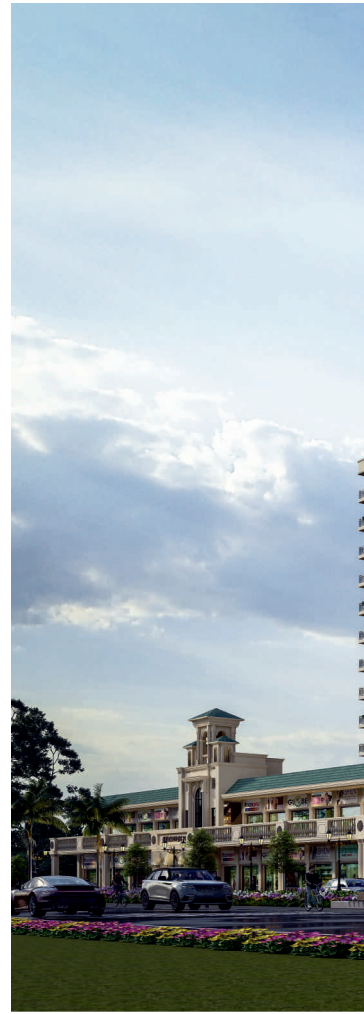





*Perspective view may vary

Welcome to Maulshree Heights

Affordable housing in Faridabad's prime location

For those who like to live life on their own terms, affordability must never get in the way of dreams. This is why we have taken it upon ourselves to turn this dream into reality.

In the heart of Faridabad's Sector 84, Arttech Affordable Housing LLP brings its new project – Maulshree Heights. Spanning an expansive area of approx 7 acres , the project brings 1, 2, and 3 BHK houses for those who seek a life of comfort and convenience. The entire project has been designed with keeping in a healthy environment wherein it encompasses ample sunlight and fresh air, with open spaces all around.



*Perspective view may vary

SITE PLAN



DISCLAIMER: SITE PLAN IS FOR ILLUSTRATIVE PURPOSES ONLY AND ARE INTENDED TO CONVEY THE CONCEPT AND VISION OF THE PROJECT. THEY ARE FOR GUIDANCE ONLY. MAY ALTER AS WORK PROGRESSES AND DO NOT NECESSARILY REPRESENT A TRUE AND ACCURATE DEPICTION OF FINISHED PRODUCT AND SPECIFICATION MAY VARY.



**PLEASE REFER DISCLAIMER & SPECIFICATION PAGE
*PRICE SHALL BE BASED ON CARPET AREA

1BHK UNIT PLAN

AREA STATEMENT	
DESCRIPTION	AREA
LOBBY/DINING	12'-0" x 11'-0"
KITCHEN	6'-0" x 10'-0"
BEDROOM	15'-0" x 10'-0"
TOILET-1	7'-6" x 4'-1"

UNIT AREA DETAIL

- CARPET AREA = 372.133 SQ.FT.
- BALCONY AREA = 23.440 SQ.FT.



**PLEASE REFER DISCLAIMER & SPECIFICATION PAGE
 *PRICE SHALL BE BASED ON CARPET AREA

2 BHK UNIT PLAN

AREA STATEMENT	
DESCRIPTION	AREA
LOBBY/DINING	10'-0" x 14'-8"
KITCHEN	6'-0" x 10'-0"
BEDROOM-1	11'-0" x 14'-0"
TOILET-1	7'-6" x 4'-1"
BEDROOM-2	15'-0" x 10'-0"

UNIT AREA DETAIL

- CARPET AREA = 594.711 SQ.FT.
- BALCONY AREA = 178.704 SQ.FT.



**PLEASE REFER DISCLAIMER & SPECIFICATION PAGE
 *PRICE SHALL BE BASED ON CARPET AREA

3BHK UNIT PLAN

AREA STATEMENT	
DESCRIPTION	AREA
LOBBY/DINING	12'-0" x 11'-0"
KITCHEN	6'-0" x 10'-0"
BEDROOM-1	15'-0" x 10'-0"
TOILET-1	7'-6" x 4'-1"
BEDROOM-2	10'-0 x 12'-0"
BEDROOM-3	10'-0 x 13'-0"
TOILET-2	4'-8" x 7'-0"

UNIT AREA DETAIL

- CARPET AREA = 645.517 SQ.FT.
- BALCONY AREA = 164.883 SQ.FT.



It's All in the Details

At Maulshree Heights, we have planned every detail with meticulousness to give residents the comfort of a grand and modern lifestyle.

Spacious Room Size:

Every room in individual units are designed to maximize space and give you convenience.

Feature-laden Units:

Live amidst the freshness of lush green trees in surrounding earthquake-resistant RCC units with dedicated green areas and ample parking.

Podium Park:

The residential project features the first-of-its kind podium park with play areas for children and dedicated walkways and tracks for the fitness enthusiasts and leisure seekers.

State-of-the-art Commercial Complex:

The project includes a State of ART commercial complex with amenities including cafes, restaurants, and shopping facilities for the convenience of residents.

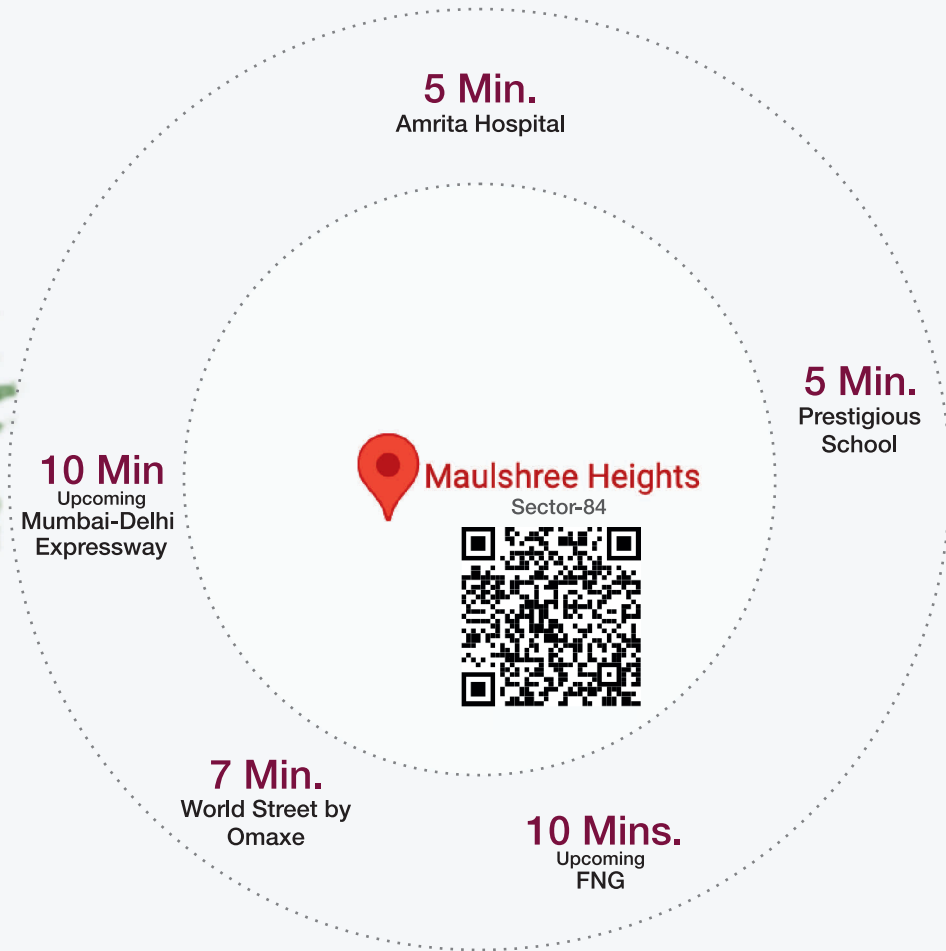

IMAGE IS FOR REFERENCE ONLY

Specification

Flooring	Rooms / Kitchen / Toilet : Ceramic tiles Balcony : Ceramic tiles Class II Common Areas : Ceramic tiles/Stones or any other materials as may be decided by the developer
Door/Window frame	MS Z section frame /Press Steel/Aluminium or any other material as may be decided by the developer
Door shutter	Flush Doors Painted with Paint or any other material as may be decided by the developer
Wall Tiles	Bathroom Ceramic Tiles upto 5 feet height Kitchen Ceramic Tiles upto 2 feet height above counter
Kitchen Counter top	Stone / IPS
Wall finish	Colour wash /Dry distemper
Plumbing fitting	PPR Pipes/CPVC Pipes/UPVC Pipes or equivalent
Sanitary fitting	Chinaware and CP Fittings
Electric Switches /Wiring	ISI Marked or equivalent
Structure	RCC frames Structure designed for SESMIC forces as per latest IS Code

Turn your dream home into a reality with us in Greater Faridabad's well developed sector-84.



ARTTECH AFFORDABLE HOUSING LLP

Corp Off.: GF-10 & 11, Ozone Centre Sector-12, Faridabad-121007 (Haryana)

RERA No.: HRERA-PKL-1050-2022(Temp ID) | Licence. No.: 112 of 2021 | Building Plan: ZP-1571/JD(NK)/2022/37046

Phone Number: 0129-4570000 | Mobile: 8151848484

E-mail: sales@arttechllp.com

www.arttechllp.com



Finance Facility Available

